

# Lista sa podacima o proizvodima

Specifikacije



Beacon, Harmony XVR, Illuminated beacon with buzzer, green, 100mm, 70...90dB, integral LED, 12...24V DC

XVR3B03S

## Osnovne informacije

Grupa proizvoda	Harmony XVR
Tip proizvoda ili komponente	Svetiljka
Kratko ime uređaja	XVR3
Tip baze svetleće kolone ili semafora	LED jedinica
zvučni signal	Zujalica: 70...90 dB at 1 m
Prečnik za montiranje	100 mm
Svetlosni izvor	LED, zelena
Primena uređaja	Automated guided vehicle (AGV) Buldozer Forklift

## Dopunske informacije

Tip signalizacije	Rotacija Treperenje Treperenje
Način spajanja	Unapred sastavljeno
Materijal	PC (polikarbonat): sočiva PBT (polybutylene terephthalate) + PC (polycarbonate): telo EPDM (ethylene propylene diene monomer): baza
[us] nazivni napon napajanja	12...24 V DC
[ue] nazivni napon	10...30 V DC
Udarna struja	3 A
Potrošnja	3,1 W
Označavanje	Procesna industrija i infrastruktura
pravac instalacije	Upright zatvoreni Sideways zatvoreni Inverted zatvoreni Upright na otvorenom
Električna klasa izolacije	Klasa II
Potrošnja struje	3000 mA
Dužina	100 mm
Širina	100 mm
Visina	139 mm
masa proizvoda	0,538 kg

## Okruženje

Sve cene koje su navedene u ovom cenovniku su informativne i neobavezujuće, bez PDV-a, isključivo u odnosu na ovlašćene distributere kompanije Schneider Electric. Svi prikazi, opisi i tehničke specifikacije i podaci u ovom cenovniku su podložni promenama od strane kompanije Schneider Electric bez prethodne najave.

Temperatura okoline za rad uređaja	-20...50 °C
Temperatura okoline za skladištenje	-35...70 °C
Relativna vlažnost	35...85 % bez kondenzacije
otpornost na vibracije	4.6 gn (sideways) 4.6 gn (inverted) 7.1 gn (upright)
IP stepen zaštite	IP23 (sideways) IP23 (inverted) IP23 (upright)

## Pakovanje

Unit Type of Package 1	PCE
Number of Units in Package 1	1
Package 1 Height	18,200 cm
Package 1 Width	13,400 cm
Package 1 Length	13,600 cm
Package 1 Weight	678,000 g
Unit Type of Package 2	S04
Number of Units in Package 2	8
Package 2 Height	30,000 cm
Package 2 Width	40,000 cm
Package 2 Length	60,000 cm
Package 2 Weight	6,406 kg

## Ugovorna garancija

Garancija (u mesecima)	18
------------------------	----

## Environmental Data

Schneider Electric namerava da postigne nulti status do 2050. godine kroz partnerstva sa lancem snabdevanja, materijale sa manjim uticajem i cirkularnost kroz našu tekuću kampanju "Use Better, Use Longer, Use Again" za produženje životnog veka proizvoda i reciklaže.

[Objašnjeni Environmental Data >](#)

[Kako procenjujemo održivost proizvoda >](#)

### Use Better

#### Materijali i pakovanje

Pakovanje sa recikliranim kartonom

Da

Pakovanje bez plastike

Da

Direktiva RoHS

[Uskladenost Sa Oslobađanjem](#)

Uredba REACH

[Referenca sadrži SVHC iznad propisanog praga](#)

### Use Longer

#### Produženje trajanja veka

Popravka

Ne

### Use Again

#### Prepakovanje i prefabrikovanje

Povraćaj

No

Dimensions Drawings

Dimensions

---

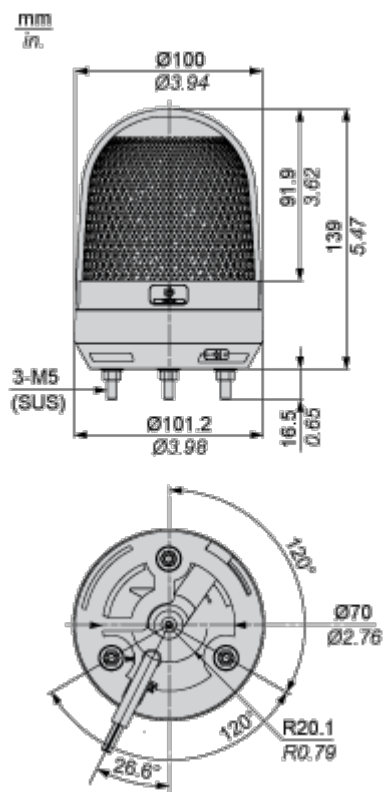

Mounting and Clearance

Panel Cut-out

---

Straight wiring

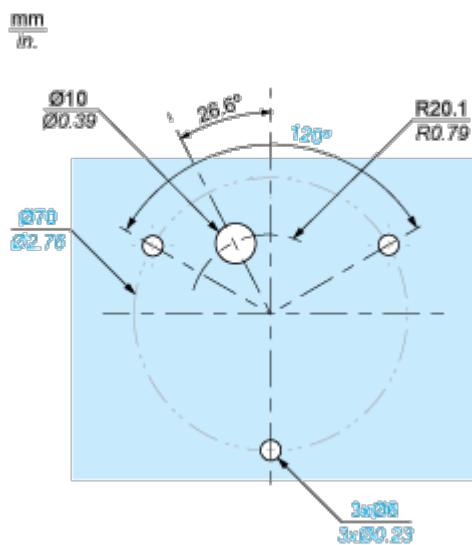

Side wiring

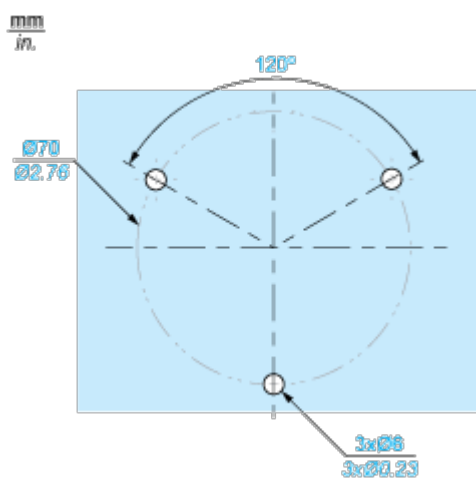

Connections and Schema

Wiring Diagram

---

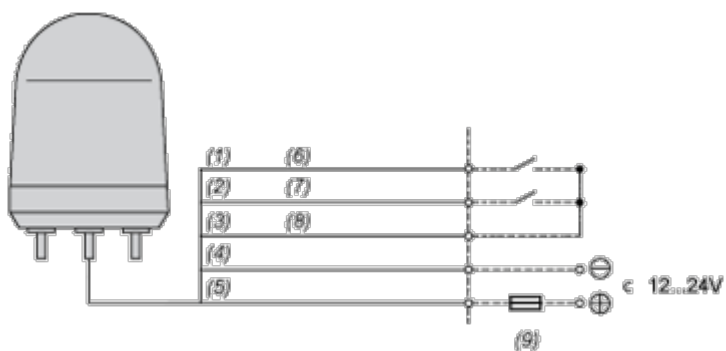

- (1) Green
- (2) Red
- (3) Yellow
- (4) Black
- (5) White
- (6) LED
- (7) Buzzer
- (8) Com
- (9) Fuse(Rated Current>2A)



Technical Illustration

Wiring diagram

---

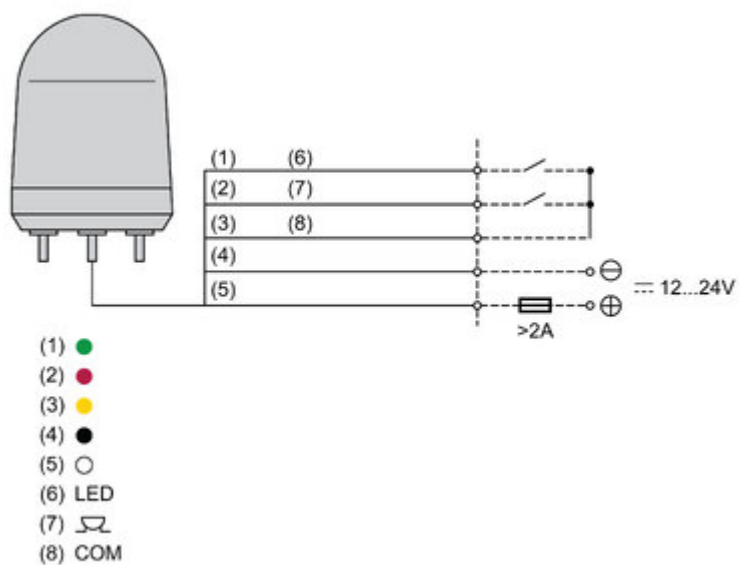

Offer Marketing Illustration

Product benefits / Features

---

## Technical Benefits

Harmony XVR3

Conforms with international IEC standards as well as CE, UL and CCC marking

Protection ratings up to IP65 and vibration resistance to increase reliability



Can be mounted in diverse positions: upright, sideways, and inverted

Motor-less super-bright LED with 360° visibility



Operating temperature from -10 °C to 50 °C

Offer Marketing Illustration

Product benefits / Features

---



The infographic features a central image of a blue, dome-shaped industrial light fixture with a perforated top and a black base. The base has the Schneider Electric logo. The background is a solid green color. The word 'Features' is written in white at the top, with 'Harmony XVR3' below it. Five circular icons are arranged around the central image, each with a corresponding text block describing a feature.

### Features Harmony XVR3

- 4 colors with 10 light patterns to select with one switch**
- Simplified installation (pre-cabled and pre-assembled products) and easy maintenance**
- High visibility of machine status**
- Buzzer volume adjustment through a built-in switch**
- Available in various diameters to suit different industrial applications**

Image of product / Alternate images

Alternative

---

